

BREAKDOWN OF DISTRIBUTOR

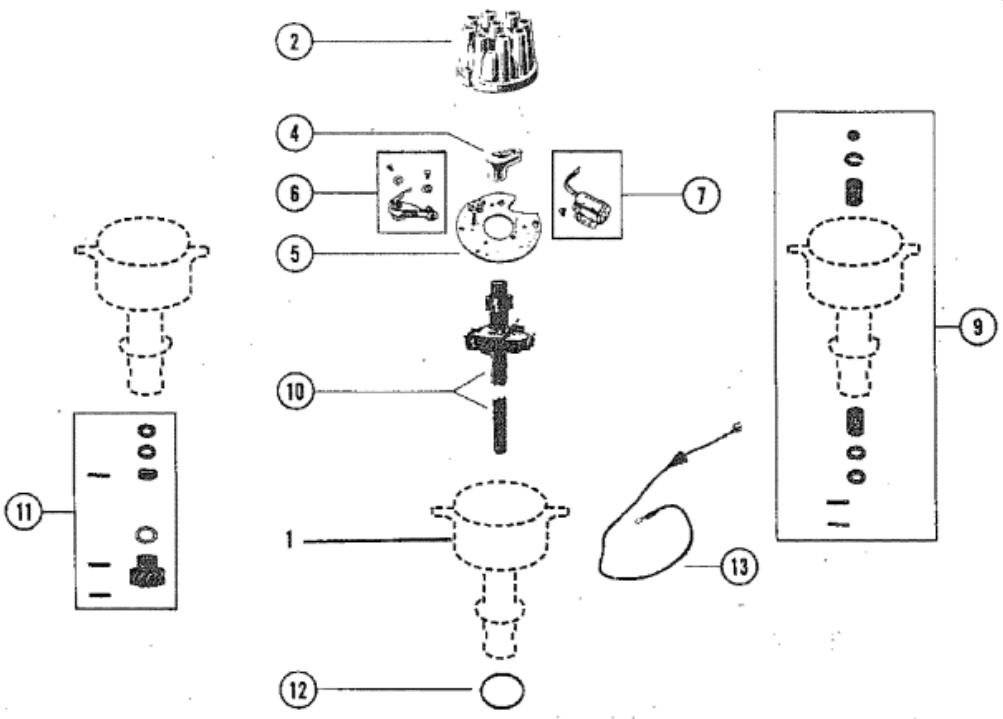

| Parts List | | | | | | |
|------------|-------|------|------------------------------|-----|---------|----------|
| Ref | Class | Part | Description | Qty | Comment | Footnote |
| 1 | 392 | 6316 | DISTRIBUTOR (L/H CR/SHAFT R) | 1 | | |
| 1 | 392 | 8739 | DISTRIBUTOR (R/H CR/SHAFT F) | 1 | | |
| 2 | 392 | 9766 | CAP DISTRIBUTOR | 1 | | |
| 4 | 392 | 9767 | ROTOR | 1 | | |
| 5 | 392 | 6323 | PLATE | 1 | | |
| 6 | 392 | 6325 | BREAKER | 1 | | |
| 7 | 392 | 6324 | CONDENSER | 1 | | |
| 9 | 392 | 6317 | BEARING | 1 | | |
| 10 | 392 | 9769 | SHAFT | 1 | | |
| 11 | 392 | 9770 | GEAR AND COLLAR (L/H CR/SI) | 1 | | |
| 11 | 392 | 9771 | GEAR AND COLLAR (R/H CR/S) | 1 | | |
| 12 | 392 | 6333 | O-RING (1-1/2" O.D.) | 1 | | |
| 13 | 392 | 9088 | PRIMARY LEAD | 1 | | |